

# IVECO

## TRAKKER

**ACTIVE DAY AD340T4IB**

**ACTIVE TIME AT340T4IB**



**Single reduction - 8x4 Mixer**

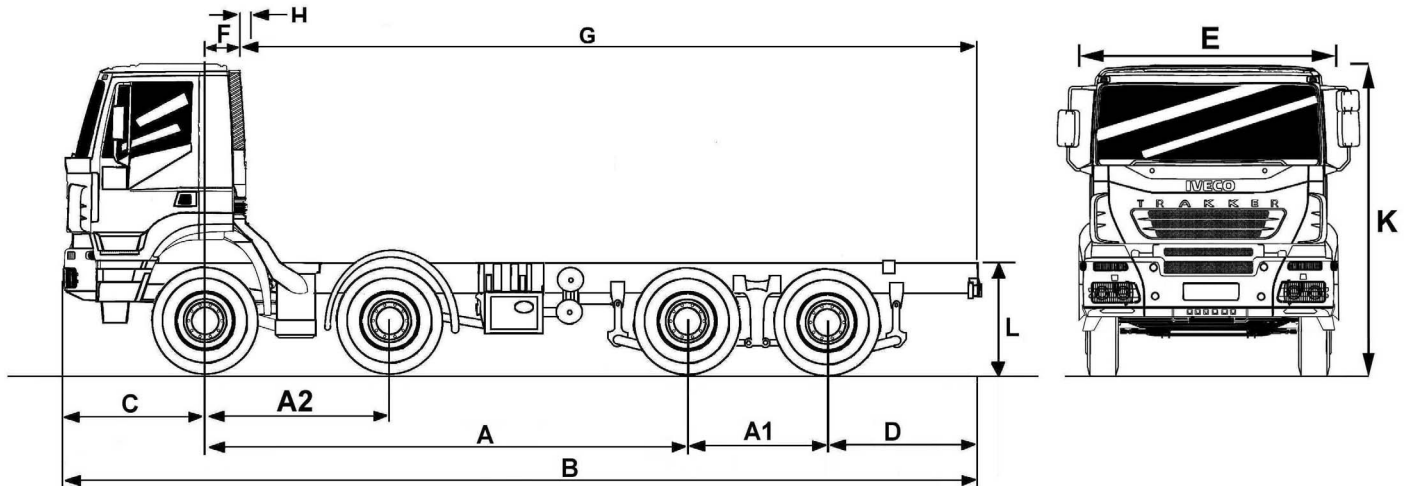

<b>PLATED/DESIGN WEIGHTS (kg)</b>		<b>GVW</b>	<b>GTW</b>	<b>Front Bogie</b>	<b>Rear Bogie</b>
Plated weights		32000	32000	16000	19000
Design weights		32000	44000	16000	21000
		<b>Day</b>	<b>Sleeper</b>		
<b>KERBWEIGHTS (kg) WHEELBASE</b>		<b>5020</b>	<b>5820</b>		
Front		6500	6655		
Rear		3110	3125		
Total		9610	9780		
<b>MAXIMUM BODY/ PAYLOAD (kg) GVW</b>		22390	22220		
<b>DIMENSIONS (mm)</b>					
<b>A</b> Wheelbase		5020	5820		
<b>A1</b> Rear bogie spread		1380	1380		
<b>A2</b> Front bogie spread		1875	1875		
<b>B</b> Overall length (over bumpers)		9370	9900		
<b>C</b> Front overhang		1440	1440		
<b>D</b> Rear overhang		1495	1225		
<b>E</b> Cab width (over front bumper)		2550	2550		
<b>F</b> C/line f/axle to back of cab equip		750	1190		
<b>G</b> Back of cab to end of frame		7145	7235		
<b>H</b> Cab gap		800	1240		
<b>K</b> Cab height (unladen)		3085	3085		
<b>L</b> Frame height		1100	1100		
Frame thickness		7.7	7.7		
Turning circle (wall to wall)		20450	22450		
<b>TYRES &amp; WHEELS</b>		<b>Tyre Size</b>	<b>Tread</b>	<b>Wheels</b>	
		<b>Front</b>	<b>Rear</b>	<b>Front</b>	<b>Rear</b>
Standard		315/80R22.5	315/80R22.5	On Road	On Road
Optional		315/80R22.5	315/80R22.5	On Road	Off Road
Optional		385/65R22.5	315/80R22.5	On Road	Off Road
				22.5x9.00	22.5x9.00
				22.5x9.00	22.5x9.00
				22.5x11.75	22.5x9.00

#### NOTES

Weights are to standard specification and include water, oils, 5 litres of AdBlue and 20 litres of fuel but excludes driver. Kerb weights are subject to a manufacturing tolerance of +/-5%. Medium roof sleeper cab adds 625mm height and 230kg. ZF 16S 2220 TO manual gearbox adds 60kg.

July 2006

# IVECO

## TRAKKER

### ACTIVE DAY

### AD340T4IB

### ACTIVE TIME

### AT340T4IB



## Single reduction - 8x4 Mixer

<b>ENGINE</b>	Iveco Cursor 13
Cylinders	6
Bore (mm)	135
Stroke (mm)	150
Capacity (litres)	12.88
Power (PS/kW)	410/301.5
@ rpm	1515 -1900
Torque (Nm/lbft)	1900/1401
@ rpm	1000 -1515
Green Zone @ rpm	1000 -1400
Rating	Euro 4/5
Cooling Fan	2 speed electro- magnetic
Fuel System	Unit Injector System
Turbocharger	Waste gate
Engine PTO	Flange coupling
Exhaust	Vertical SCR catalyst system
Speed Limiter	Standard 90 Kilometer/hr @ 1348 rpm
Engine Immobiliser	Standard
Vehicle data interface	Optional

<b>GEARBOXES</b>	Eurotronic AS2330 TO	ZF 16S 2220 TO
1 <sup>st</sup>	12.33	13.80
2 <sup>nd</sup>	9.59	11.54
3 <sup>rd</sup>	7.44	9.49
4 <sup>th</sup>	5.78	7.93
5 <sup>th</sup>	4.57	6.53
6 <sup>th</sup>	3.55	5.46
7 <sup>th</sup>	2.70	4.57
8 <sup>th</sup>	2.10	3.82
9 <sup>th</sup>	1.63	3.02
10 <sup>th</sup>	1.27	2.53
11 <sup>th</sup>	1.00	2.08
12 <sup>th</sup>	0.78	1.74
		1.43
		1.20
		1.00
		0.84
Rev 1	11.41	12.92
Rev 2	8.88	10.80

#### PERFORMANCE

– with Eurotronic AS2330 TO gearbox and standard tyres

Axle Ratios Available	<b>3.78</b>	3.40	4.12	4.50
Gear Speed (mph)	<b>100</b>	111	91	84
Gradeability % @ GVW	<b>40+</b>	40+	40+	40+

– with ZF16S 2220 TO gearbox and standard tyres

Axle Ratios Available	<b>3.78</b>	3.40	4.12	4.50
Gear Speed (mph)	<b>92</b>	103	85	78
Gradeability % @ GVW	<b>40+</b>	40+	40+	40+

#### CLUTCH

Type	Single plate, diaphragm spring, pull type. Asbestos free
Diameter / Friction area	432 mm / 994 cm <sup>3</sup>

#### BRAKES

Type	Electronic brake limitation (EBL)
Front	436mm ventilated disc
Rear	410mm Duo-duplex drums
Iveco turbo brake (ITB)	Standard
Heated air drier	Standard
Air reservoirs	Aluminium
ABS	Standard
ASR Traction Control	Optional

#### CHASSIS

Type	Ladder construction with pressed steel side members and riveted and bolted cross members.
------	---

#### FUEL TANK

Type	300 litres, aluminium Locking fuel cap
------	---

#### Adblue Tank

Type	55 litres, plastic Locking cap
------	-----------------------------------

#### ELECTRICS

Type	24v negative earth return
Alternator	28v, 90A
Starter	24v, 5.5kW
Battery	2 x 12v, 220Ah All circuits protected by fuses Easy Mux CAN line data bus system

#### SUSPENSION

Front	Parabolic leaf
Rear	Parabolic cantilever
Anti-roll bar	Front and twin rear
Shock Absorbers	Front

#### STEERING

Type	Power assisted
Ratio	20.7

#### AXLES

Front and second steer	Iveco 5886 I-beam with oil filled hubs
Rear	MT23-155 single reduction
Diff Lock	Standard cross and inter axle
Standard Ratios	Eurotronic AS2330 TO gearbox 3.78 ZF 16S 2220 TO gearbox 3.78

#### CAB INTERIOR

**Active Day Cab:** interior incorporating, air suspended 3-way adjustable driver's seat, inertia reel belt. Passenger seat 2 way adjustable with inertia reel belt. Soft feel dashboard with multi-functional steering wheel incorporating touch button menu controls for the real time digital dash display. Automatic electronic 2 man tachograph, dual scale speedometer. All gauge functions monitored using international symbols. Heater with 4 speed fan for an airflow up to 600m<sup>3</sup>/hr, 12kW output. Left and right hand entry assist handles. Pneumatic adjustable steering column, 2 column mounted control stalks, left stalk operating the indicators, main beam, windscreen wash wipe, right stalk operating Eurotronic 2 gear change, engine brake, cruise control and variable speed limiter. Left of the steering column is the dash mounted Eurotronic gearbox controls for automatic and semi-automatic modes, neutral, reverse and low speed manoeuvring mode (forward and reverse). Rear bulk head storage and writing pad. Overhead console for CB radio. Remote control radio/CD, aerial and speakers. Courtesy and map reading lights. Electronic PTO switch and in cab preparation. Door roller blinds. Easy clean cab interior.

**Active Time Cab:** Equipment as for day cab, without easy clean interior includes single low level bunk with under bunk storage writing pad, control panel, incorporating controls for electric windows, (optional electric roof vent), and interior lights, cab heating, alarm clock, and a 12V socket. Eberspacher cab heater. Curtains to enclose entire cab area.

#### CAB EXTERIOR

**Active Day:** forward control cab. Galvanised pressed steel construction, with SMC for vulnerable parts. Helical spring suspension and dampers. Hydraulic cab tilt to 60 deg. Tinted electric door windows and tinted laminated screen. Rear cab windows (AD cab only). Heated rear-view mirrors, plus kerb and wide-angle mirrors. Steel front bumper. Left and right hand rotating beacons.

**Active Time Cab:** Construction and equipment as for day cab but includes external stowage for tools.

The information in this literature is intended to be of a general nature only. Iveco Ltd reserves the right to modify or change specification at any time. For further information please consult your dealer.

July 2006